

## LEAK SENSOR

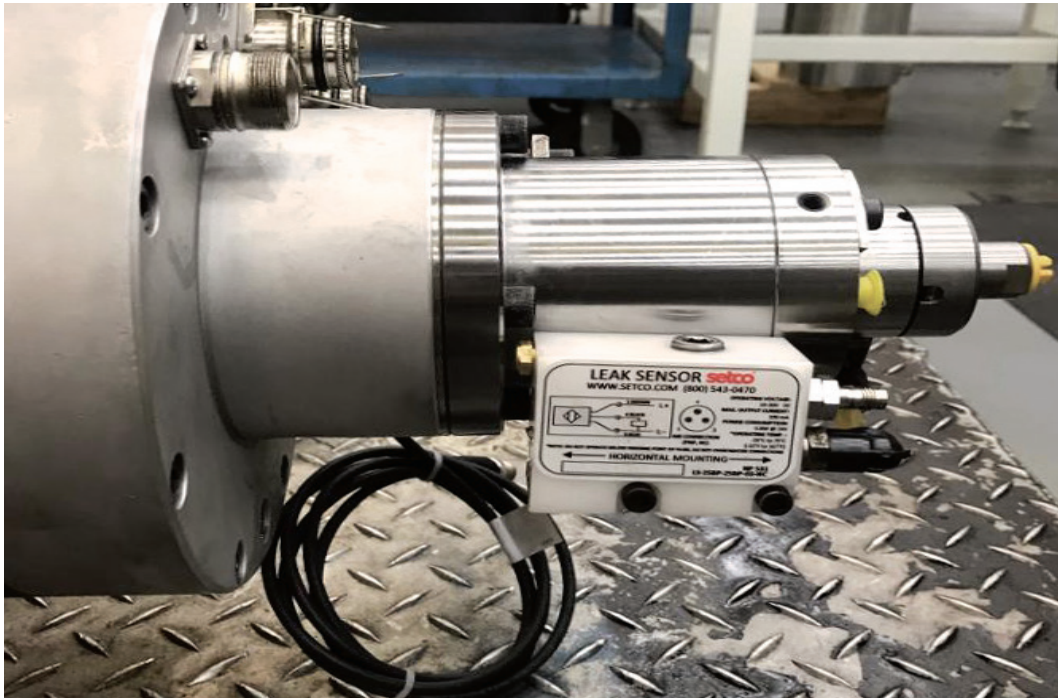

### SETCO LEAK SENSOR - PREVENTIVE MAINTENANCE FOR SPINDLES

#### Prevent spindle shutdown!

Setco's Leak Sensor sends an alert when excessive leakage of fluids are detected due to coolant union wear. The coolant union can then be replaced prior to catastrophic failure.

Coolant unions are used to transfer liquid into rotating spindle shafts from a stationary source. Coolant unions with contact seals begin to increase leakage prior to failing. If the union is not replaced in time, a serious malfunction will occur causing the liquid to spray into the spindle and onto surrounding equipment, resulting in costly damage.

#### Leak Sensor Features:

- Internal bypass after sensor activation significantly delays liquid from backing up drain line into union; thus provides time to replace union
- Alerts when drainage is too high; indicating union must be replaced
- Works with conductive and non-conductive liquids
- Outputs an electrical signal for machine alarm
- Electrical components are not in direct contact with liquid, resulting in longer-life



# SPECIFICATIONS

## SIZE SPECIFICATIONS

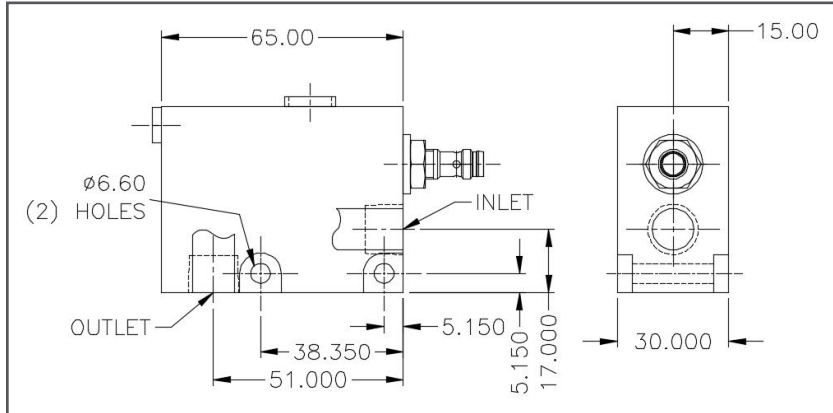

## SENSOR ELECTRICAL SPECIFICATIONS

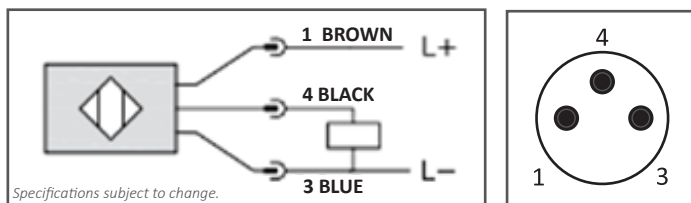

## STANDARD MOUNTING ORIENTATION

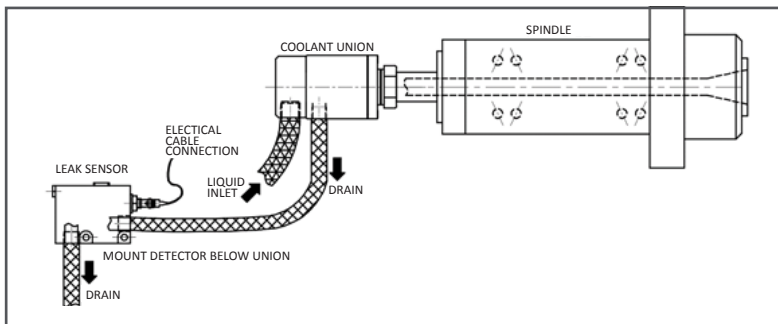

## OPERATING INFORMATION

	Normally Open	Normally Closed
<b>Sensor Style - PNP</b>	Normally Open	Normally Closed
<b>Short Circuit Protection</b>	YES	YES
<b>Supply Voltage (SV)</b>	0-30V DC	10-30V DC
<b>Output Voltage (SV)</b>	(SV) - 2V	(SV) - 2V
<b>Max. Output Current</b>	80 mA	190 mA
<b>Power Consumption</b>	2.4W @ 24V	4.8W @ 24V
<b>Operating Temperature*</b>	-25°C to 75°C [-22°F to 167°F]	-25°C to 75°C [-22°F to 167°F]

\*Do not operate below freezing point of liquid or above boiling point of liquid

\*Liquid must be compatible with nylon, stainless steel, nickel, and polypropylene

## OPTIONS AND ORDERING DETAILS

Inlet/Outlet Size	Sensor No/NC	Part No. for Ordering
1/4 NPT	NO	LS-25N-25N-03-NO
1/4 NPT	NC	LS-25N-25N-03-NC
G 1/4 (BSPP)	NO	LS-25BP-25BP-03-NO
G 1/4 (BSPP)	NC	LS-25BP-25BP-03-NC

Setco is the technical leader in the design, manufacture, and service of precision spindles, milling heads, slides, and spindle/slide combinations. With the largest variety of spindles, new and rebuilt, including belt-driven, geared, motorized, high-speed and high-frequency models, Setco is a major spindle manufacturer. Through its ten global locations, Setco is the industry forerunner in the repair and servicing of spindles for over 350 machine tool brands.

## 📍 SERVICE CENTERS

### MIDWEST SERVICE CENTER\*

**Corporate HQ**  
5880 Hillside Avenue  
Cincinnati, OH 45233  
(513) 941-5110  
1 (800) 543-0470 Toll-Free

### SOUTHEAST SETCO

2402 Tech Center Pkwy, Suite 200  
Lawrenceville GA 30043  
(678) 407-6206  
1 (800) 830-4992 Toll-Free

### GREAT LAKES SERVICE CENTER

41129 Jo Drive  
Novi, MI 48375  
(248) 888-8989  
1 (877) 773-5349 Toll-Free

### WEST COAST SERVICE CENTER

5572 Buckingham Drive  
Huntington Beach, CA 92649  
(714) 372-3730  
1 (866) 362-0699 Toll-Free

### MEXICO SERVICE CENTER

Bldv. Las Torres 418 A  
Colonial Molinos del Rey  
Ramos Arizpe,  
Coahuila, Mexico CP 25903  
(442) 824-1445

CHINA | INDIA | MEXICO | TAIWAN

# setco®

Spindles | Milling Heads  
Slides | Custom Engineering